

RESOLUTION No. 2023-07-18-1

WHEREAS, Dyer, Arkansas recognizes the need to provide public recreation facilities for its local citizens and visitors, and

WHEREAS, the City wishes to apply for FUN Park grant funds through the Arkansas Department of Parks, Heritage and Tourism to develop a public park at the following location: Dyer City Park; and

WHEREAS, the Mayor and the City Council understand that if granted funds for park development, they must provide land, by lease or ownership, on which to develop park facilities; and

WHEREAS, Dyer, Arkansas will sign a contract agreeing to provide the necessary resources to maintain this park and facilities for a period of 25 years;

NOW, THEREFORE, BE IT RESOLVED the City Council of Dyer, Arkansas hereby authorizes the Mayor to submit an application for grant funding to the Arkansas Department of Parks, Heritage and Tourism to develop a public park.

Passed this 18<sup>th</sup> day of July, 2023

APPROVED:

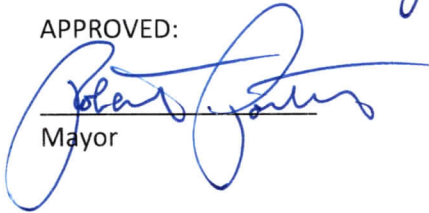
  
\_\_\_\_\_  
Mayor

  
\_\_\_\_\_  
Clerk



REVISION	DATE	DESCRIPTION

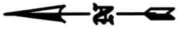
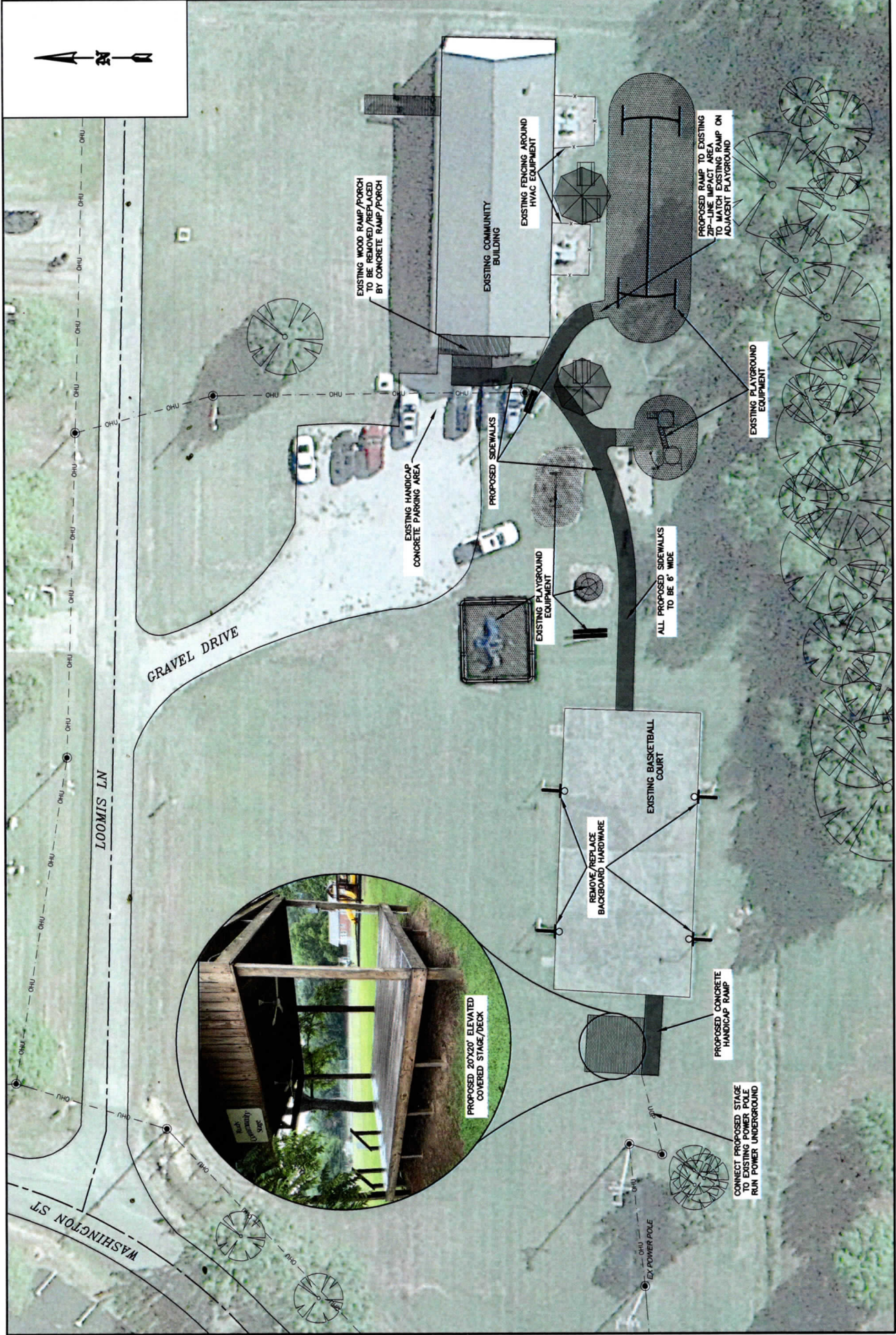



**ENGINEER'S PRELIMINARY OPINION OF PROBABLE COST**

DYER COMMUNITY CENTER  
CRAWFORD COUNTY, ARKANSAS  
JULY 2023

Item No.	Est. Quantity	Unit	Item Description	Unit Price	Extension
1	170	LF	Concrete Sidewalks (6' Wide)	\$ 100.00	\$ 17,000.00
2	180	LF	4" of Compacted Base Material (SB-2, 8' Wide)	\$ 15.00	\$ 2,700.00
3	1	LS	Removal of Existing Porch/Ramp & Underlying subgrade	\$ 5,000.00	\$ 5,000.00
4	1	LS	8' x 35' Concrete Patio/Porch w/ 3' x 15' Handicap Ramp	\$ 30,000.00	\$ 30,000.00
5	1	LS	New Ramp to Zip-Line Impact Area	\$ 1,200.00	\$ 1,200.00
6	1	LS	6' x 28' Concrete Handicap Ramp	\$ 10,000.00	\$ 10,000.00
7	1	LS	Remove/Replace Existing Backboard Hardware	\$ 1,500.00	\$ 1,500.00
8	1	LS	Seeding, Mulching, and Restoration	\$ 2,500.00	\$ 2,500.00
9	1	LS	20' x 20' Elevated Covered Stage/Deck	\$ 20,000.00	\$ 20,000.00
SUBTOTAL CONSTRUCTION COSTS					\$ 89,900.00
ENGINEER'S PRELIMINARY OPINION OF PROBABLE CONSTRUCTION COSTS					<b>\$ 89,900.00</b>
ENGINEERING DESIGN, BID, INSPECTION, CLOSE-OUT (EXCLUDING BOUNDARY & TOPO SURVEYS)					\$ 10,000.00
<b>Total Estimated Cost</b>					<b><u>\$ 99,900.00</u></b>